

Flash Patterns						
Pattern	Pattern Description	Amber	White	Red	Blue	Green
0	Random					
1	Steady*					
2	Ultra Ph2	●	●	●	●	
3	Single Fast					
4	Double Fast					
5	Single Ph2	●▲	●	●▲	●▲	
6	Quad Fast					
7	Double Ph2	●	●	●	●	
8	S.O.S.*					
9	2 Double + 2 Quad					
10	4 Single + 2 Triple					
11	Quint Ph2					
12	8 Flash					
13	4 Mega + 4 Quad					
14	4 Single + 4 Mega					
15	Single + Triple + Quint					
16	F + Double + F + Quad + F + Flash					
17	Single Quick					
18	Single	●▲	●	●▲	●▲	
19	Double	●	●	●	●	
20	Triple	●	●	●	●	
21	Quad	●	●	●	●	
22	Ultra	●	●	●	●	
23	Quint					
24	Mega*	●	●	●	●	
25	Single + Quad					
26	Single H/L					
27	Single Pulse*	●	●	●	●	
28	Double Pulse*	●	●	●	●	

*= No Alternate Function Available, Ph2 = Group 2, ● = SAE Class1, ▲ = California Title 13

Color Legend for Tri and Quad Color				
Colors				
Model	Color 1	Color 2	Color 3	Color 4
RGYW	Amber	White	Red	Green
RBYW	Amber	White	Red	Blue
YGW	Amber	White	Green	
BYW	Amber	White	Blue	
RYW	Amber	White	Red	
RGY	Red	Amber	Green	
RWB	Blue	White	Red	

Color Setting for Quad-Color	
Setting #	Colors
1	Color 1
2	Color 2
3	Color 3
4	Color 4
5	Color 1 & 2
6	Color 1 & 3
7	Color 1 & 4
8	Color 2 & 3
9	Color 2 & 4
10	Color 3 & 4
11	Color 1 & 2 & 3
12	Color 1 & 2 & 4
13	Color 1 & 3 & 4
14	Color 2 & 3 & 4
15	Color 1 & 2 & 3 & 4

Color Setting for Tri-Color	
Setting #	Colors
1	Color 1
2	Color 2
3	Color 3
4	Color 1 & 2
5	Color 1 & 3
6	Color 2 & 3
7	Color 1 & 2 & 3

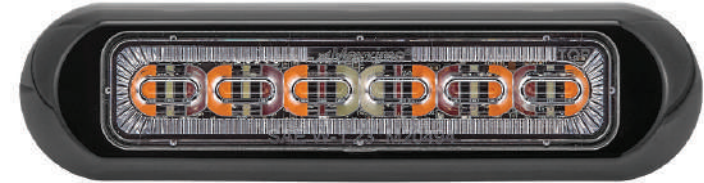

M20494 Tri & Quad Warning Lights INSTRUCTION MANUAL

Led Color	Tri: YGW, BYW, RYW, RGY, RWB Quad: RGYW, RBYW
Voltage	12V / 24V
Patterns	28
SAE	J595 Class 1, CA13
Material	PC Lens, AL Base
Mount	2x Screw Holes

Additional Information

- ▶ 7 or 15 Flash Color Options
- ▶ 11 Programmable Memory Slots
- ▶ Available Dim Feature
- ▶ Available Sync & Alternate Patterns
- ▶ 5 Year Warranty

CAUTION

- Carefully select the mounting location for the warning light, avoiding areas that may impair visibility or distract the vehicle's operator. Improper placement could obstruct the operator's view or divert their attention, potentially leading to serious accidents.
- For cleaning the outer lens of the warning light, only use a mixture of soap and water. Utilizing other chemicals may lead to premature cracking or discoloration of the lens. Damaged lenses can significantly impede the warning light's functionality. Regularly inspect and operate the warning light to ensure it is working optimally.

MEASUREMENTS

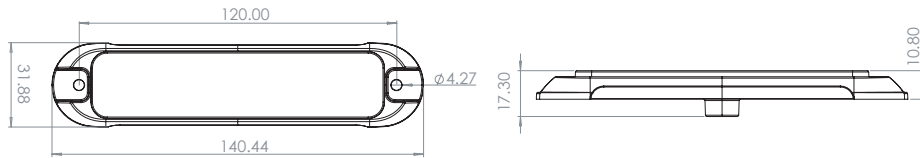

All dimensions are in millimeter (mm)

ELECTRICAL WIRING & CONFIGURATION

NOTE: Ensure that the vehicle's battery is disconnected before making electrical connections.

The M20494 Warning Light Series comes with 5 wires as shown below. The red, brown, and white wires are used in conjunction to enable a specified memory slot. Each of the eleven memory slots can save one pattern, color setting, and dim setting. Depending on the number of memory slots being used, various switch setups may be utilized. Refer to **Switch Control Setup** for possible setups using ON/OFF, and Two or Three Position switches. For instance, if ON/OFF or 2 position switches are used, up to 7 memory slots may be used. Setups using ON/OFF or 2 Position switches should have them tied to VDC (+). However, if 3 Position switches are used, up to 11 memory slots may be used. With 3 Position switches both VDC(+) and Ground (-) should be tied to them.

These Warning lights include 28 flash patterns. Each pattern has a selection of color modes depending on the model. Optionally, if alternating patterns are needed between warning lights, you may do so in a two group setup. One group of lights will need to have their white wire tied to ground. The other group should have their white wire not connected. Another way to configure alternating lights is by using the patterns marked with a Ph2 for group 2, along with their non Ph2 variants for group one. For instance, you can have group two set to pattern "Single Ph2" and group one to pattern "Single." This will cause an alternating single flash pattern between the two groups. To sync patterns between lights, the yellow wires must be tied to each other.

NOTE: Not all patterns support the alternating function. Refer to **Flash Patterns**.

Wire color Function

Yellow — Trigger (+) — (Momentary switch (optional) (+))
 Red — (+), (-), or NC
 Brown — (+), (-), or NC
 White — (+), (-), or NC
 Black — Ground (-)

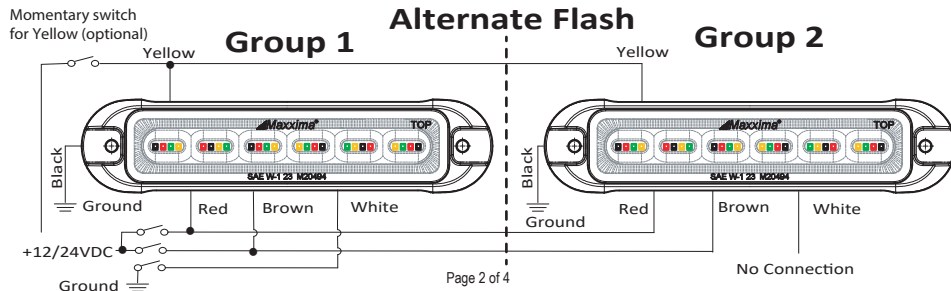
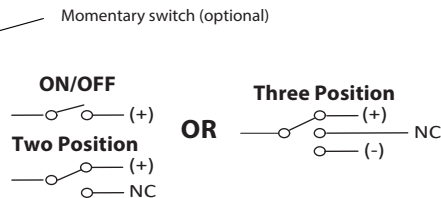

Page 2 of 4

No Connection

ELECTRICAL WIRING & CONFIGURATION

Step 1 Connect all Black wire to vehicle Ground (-).

Step 2 Connect all Brown wire to a switch.

Step 3 Connect all Red wire to a switch.

Step 4 Optionally connect all White wire to a switch.

Step 5 Select Memory Slot by flipping the switches accordingly.

Step 6 Program the Warning Light to the desired pattern by tying the Yellow wire to (+) for a set number of seconds.

Yellow Wire Functions	
Seconds	Action
0-2	Change Pattern
2-5	Change Color
5-7	Toggle Dim Mode
7+	Change to Factory Default

Switch Control Setup			
Switch Type	Quantity	Wires	No. of Memory Slots
ON/OFF or 2 Position	2	RB	Up to 3
	3	RBW	Up to 7
3 Position	2	RB	Up to 5
	3	RBW	Up to 11

R = Red Wire, B = Brown Wire, W = White Wire

Memory Slot Configuration											
Memory Slots											
Wire Color	1	2	3	4	5	6	7	8	9	10	11
Red :	(+)	NC	(+)	(+)	(-)	NC	(+)	NC	(+)	(+)	(-)
Brown :	NC	(+)	(+)	(-)	(+)	NC	NC	(+)	(+)	(-)	(+)
White :	NC or (-) for Alternate					(+)	(+)	(+)	(+)	(+)	(+)
Black :	(-)										
Yellow :	(+) Pattern Switch, Sync, Color Switch, & Dim Toggle										
Model	M20494 Triple-Color Factory Default										
Pattern	0	0	0	0	0	8	1	1	1	1	1
Color Set #	7	1	2	3	4	7	7	1	2	3	4
Dim Mode	OFF	OFF	OFF	OFF	OFF	OFF	OFF	OFF	OFF	OFF	OFF
Model	M20494 Quad-Color Factory Default										
Pattern	0	0	0	0	0	8	1	1	1	1	1
Color Set #	15	1	2	3	4	15	15	1	2	3	4
Dim Mode	OFF	OFF	OFF	OFF	OFF	OFF	OFF	OFF	OFF	OFF	OFF

Mounting

NOTE: Before beginning the warnig light installation, ensure that the mounting location is clear of all obstructions.

Tools needed for installation are a drill bit with a diameter of 1/8" for the two mounting holes. Another drill bit with a diameter of 1/2" is needed for the wire extrusion on the back.

Before placing the warning light, ensure that the bezel is removed to access the mounting holes. Once the warning light is in place, secure it using the two provied philips head screws. To complete the installation, snatch the provided bezel onto the light.

Page 3 of 4